

REVISION HISTORY			
REV	DESCRIPTION	DATE	APPROVED
A	ORIGINAL RELEASE	4-24-2014	

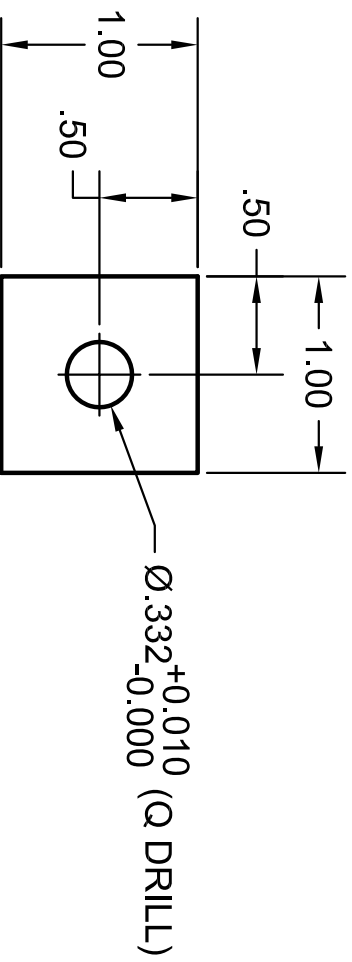

NOTE 1: BREAK EDGES & CORNERS

MATERIAL: ASTM A1011/A1011M-14 HOT ROLLED STEEL FLAT BAR.
 GRADE 36
 .125 THICK

DIMENSIONING & TOLERANCING IN ACCORDANCE WITH ANSI/ASME Y14.5M - 1994

THIRD ANGLE

THIS DRAWING AND/OR SPECIFICATION CONTAINS INFORMATION THAT IS NOT CONFIDENTIAL TO THE UNIVERSITY OF MEMPHIS. BY RETENTION, THE RECIPIENT AGREES TO REPRODUCE OR COPY IT IN PART AND IN WHOLE WITHOUT WRITTEN PERMISSION, AND TO MAKE ANY USE OF IT AS SEEMS FITTING.

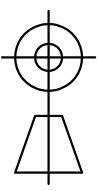

UNLESS OTHERWISE SPECIFIED: ALL DIMENSIONS ARE INCHES

UNSPECIFIED TOLERANCES

LENGTH	SURFACE FINISH
.0 = ±.1	RMS 140
.00 = ±.01	µin
.000 = ±.005	ANGULAR ±.25°
.0000 = ±.005	

UNIVERSITY OF MEMPHIS
 DEPARTMENT OF ENGINEERING TECHNOLOGY

MOUNT, PANEL
 TX MODEL EXTRUDER

SIZE	DATE	DWG NO	REV
A	4-24-2014	TX-001	A

SCALE: 1=1
 DRAWN BY: R.H.