

REVISION HISTORY			
REV	DESCRIPTION	DATE	APPROVED
A	ORIGINAL RELEASE	6-122015	

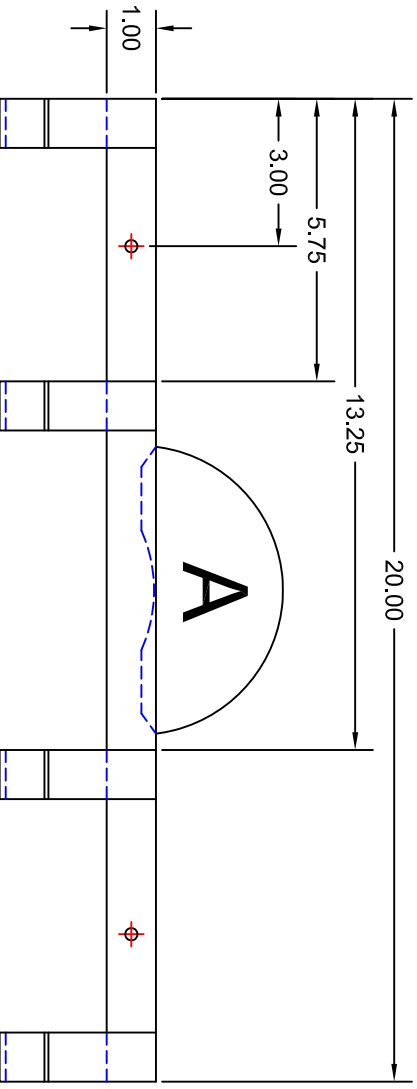

40° OF 1 X 1/26 STEEL PER STUDENT
 PLUS PRACTICE PIECE
 6" ROUND DISK
 1/8 SQ. FT PER STUDENT

WELD AS DEMONSTRATED IN CLASS

DIMENSIONING & TOLERANCING IN ACCORDANCE WITH ANSI/ASME Y14.5M - 1994

THIRD ANGLE

THIS DRAWING AND/OR SPECIFICATION CONTAINS INFORMATION THAT IS NOT CONFIDENTIAL TO THE UNIVERSITY OF MEMPHIS. BY RETENTION, THE RECIPIENT AGREES TO REPRODUCE OR COPY IT IN PART AND IN WHOLE WITHOUT WRITTEN PERMISSION, AND TO MAKE ANY USE OF IT AS SEEMS FITTING.

UNLESS OTHERWISE SPECIFIED: ALL DIMENSIONS ARE INCHES

UNSPECIFIED TOLERANCES

LENGTH $.0 = \pm .1$ SURFACE FINISH RMS 140 μ in

$.00 = \pm .01$

$.000 = \pm .005$

$.0000 = \pm .005$ ANGULAR $\pm .25^\circ$

UNIVERSITY OF MEMPHIS
 DEPARTMENT OF ENGINEERING TECHNOLOGY

TECH 1711
 WELDING LAB

SIZE	DATE	DWG NO	REV
A	6-12-2015	COATRACK	A
SCALE: 1/4=1		DRAWN BY: RH	